

SUNFIRE[®]

CR80 RADIANT HEATER

Operation & Service Manual



4109 Capital Circle Drive | Janesville WI, 53546

sunfireheaters.com | +1 (855) 251-1649



THIS PAGE INTENTIONALLY LEFT BLANK

Safety Information:

Before you begin...



SAFETY, CODES, AND REGULATIONS:

Thank you for purchasing a SunFire product. SunFire heaters are designed and tested for safe, reliable, long-term operation, though proper operation, fuel quality control, and regular maintenance are required. Please read and understand this manual completely before attempting to operate or service the product. Keep and maintain this instruction manual.

This manual provides instructions necessary to safely use the SunFire Radiant Heater. MISUSE OF THIS PRODUCT MAY RESULT IN SERIOUS OR FATAL INJURIES DUE TO BURNS, FIRE, EXPLOSION, ELECTRICAL SHOCK, OR ASPHYXIATION FROM CARBON MONOXIDE.

If you have any questions, please go to www.sunfireheaters.com or call 1 (855) 251-1649 for support.

CONVENTIONS USED IN THIS MANUAL:

For your safety, this manual uses the following definitions and signal words to identify hazards:

- ⚠ DANGER** - Indicates a hazardous situation which, if not avoided, will result in death or serious injury. This signal word is limited to the most extreme situations.
- ⚠ WARNING** - Indicates a hazardous situation which, if not avoided, could result in death or serious injury.
- ⚠ CAUTION** - Indicates a hazardous situation which, if not avoided, may result in minor or moderate injury. It may also be used to alert against unsafe practices.
- NOTICE** - Indicates an unsafe practice which, if not avoided, may result in product or property damage. Also used for general alerts.

Safety Information:

⚠ DANGER

Failure to comply with specified requirements and minimum clearances can be dangerous and may become a fire hazard. Additional clearances may be necessary for accessibility or to comply with local codes.

⚠ DANGER

This appliance is equipped with a three-prong grounding plug for your protection against electric shock hazard and should be plugged into a grounded, three-prong power supply capable of supplying proper voltage and amperage.

⚠ WARNING

USE ON LEVEL, NON-COMBUSTIBLE FLOORING ONLY

⚠ DANGER

Carbon Monoxide (CO) is a poisonous gas that cannot be seen nor smelled and can result in fatality within minutes. Not for use in residential living areas. Only use this product in a well-ventilated area.

Provide a minimum of 2.55 square feet (0.27 square meters) of ventilation to the outdoors into the operation area at the unit-height level. The first symptoms of carbon monoxide asphyxiation are similar to that of the flu: headaches, dizziness, and/or nausea. These symptoms could be caused by a malfunction of the Radiant Heater. In this case go outside immediately. Have the Radiant Heater repaired before continuing operation of the heater. Some people are more affected by the effects of carbon monoxide than others, especially pregnant women, those who suffer from heart or lung disease, or people with anemia; also those who have consumed alcoholic beverages and those who are at high altitudes. Be sure to read and understand all of the warnings. Save this manual for future reference: it will provide you with instructions to operate your radiant heater safely and correctly.

⚠ WARNING Ceramic fiber material

This appliance may contain ceramic fiber and/or fiberglass materials. Ceramic fiber materials, such as chamber liners, may contain carcinogenic particles (cristobalites) after exposure to heat. Airborne particles from fiberglass or ceramic fiber components have been listed as potentially carcinogenic by the State of California.

Take the following precautions when removing, replacing and handling these items:

Avoid breathing dust and avoid contact with skin or eyes. Wear long-sleeved, loose-fitting clothing, gloves, and eye protection.

Use a NIOSH N95 certified respirator. This respirator meets requirements for protection from cristobalites. Actual job requirements or NIOSH regulations may require other or additional protection. For information, refer to the NIOSH website, <http://www.cdc.gov/niosh/homepage.html>.

To prevent airborne dust, thoroughly wet ceramic fiber with water before handling. Place ceramic fiber materials in a plastic bag and seal it for disposal. Avoid blowing, tearing, sawing, or otherwise causing fiberglass or ceramic fiber materials to become airborne. If such operations are necessary, wear extra protection to prevent yourself or others from breathing the dust. Wash work clothes separately from other laundry. Rinse clothes washer thoroughly afterwards to prevent contamination of other clothing.

NIOSH First aid procedures: Eye exposure – irrigate immediately; Inhalation – fresh air.



! WARNING

NO GASOLINE!

This product is designed for use with Diesel, No.2 heating oil, or kerosene ONLY!

- To avoid added risk of fire or explosion, never use gasoline, crankcase drainings, naphtha, paint thinners, alcohol, or any other unapproved fuels.
- Never use the heater in areas where aerosol cans, gasoline, paint thinner, or other highly flammable materials are stored.
- Visually inspect the heater before each use. Never use a heater that has been damaged, broken, or modified from manufacturer's specifications.
- Before filling the fuel tank, extinguish all nearby flames, including the radiant heater and wait for the heater to cool down.
- While filling the tank inspect the fuel lines and their junctions to check for fuel losses. Any losses or leaks must be repaired before resuming operation of the radiant heater.
- Fuel should always be stored in compliance with safety regulations.
- When you move or store the heater, maintain it in a level position in order to avoid fuel loss or drain the fuel into an appropriate receptacle.
- Keep children and animals away from the heater.
- Disconnect the heater from electrical power when it is not in use and has completed a post-purge cycle after power button has been placed in the OFF position.
- When it is controlled by another device (like a timer), the heater could turn itself on at any time. Please be aware of this and observe all safety precautions.
- Never operate the heater in unoccupied or unattended areas.
- Do not block vents or openings on any part of the heater at any time.
- When the heater is in use and connected to the power supply, it should never be moved, handled, or refilled and no maintenance should be performed on it.

...in Canada:

- Installation of the unit shall be in accordance with the regulations of the authorities having jurisdiction. Refer to CSA standard 39-1962: Installation Code for Oil-Burning Equipment, for Recommended Installation Practice.

Safety Labels:

⚠ WARNING

READ MANUAL BEFORE USE

1. Never use gasoline or waste oil.
2. Never push RESET button more than twice. If heater doesn't start, follow troubleshooting in manual.
3. Never use in the presence of flammable vapors or dust.
4. Never unplug unit before allowing unit to cycle through the 5 minute post-purge cool down period after turning unit off.
5. Do not touch the front or top of heater until completely cool.
6. Risk of shock: Unplug unit before removing burner cover.
To be used only in well-ventilated commercial-industrial occupancies.
Not for use where exposed to the weather.
7. Never move heater while running.
8. Do not start heater after excess fuel has accumulated in the front dome chamber. Allow time to dry.
9. Do not operate heater unattended.
10. Keep heater a minimum distance of 7 feet away in the front and 3 feet on both left and right sides from flammable and combustible materials.

CAUTION: Hot while in operation. Do not touch. Keep children, clothing, and combustibles away.

⚠ AVERTISSEMENT

LIRE LE MANUEL AVANT UTILISATION

1. Ne jamais utiliser d'essence ou d'huile usée.
2. Ne jamais appuyer plus de deux fois sur le bouton RESET. Si l'appareil de chauffage ne démarre pas, suivre les instructions de dépannage dans le manuel.
3. Ne jamais utiliser en présence de vapeurs ou de poussières inflammables.
4. Ne jamais débrancher l'appareil avant de le laisser passer par le cycle de refroidissement post-purge de 5 minutes après l'avoir éteint.
5. Ne pas toucher l'avant ou le dessus de l'appareil de chauffage avant qu'il ait complètement refroidi.
6. Risque de décharge : Débrancher l'appareil avant de retirer le couvercle du brûleur. Utiliser uniquement dans des locaux commerciaux et industriels bien ventilés. Ne pas utiliser dans des lieux exposés aux intempéries.
7. Ne jamais déplacer l'appareil de chauffage pendant qu'il fonctionne.
8. Ne pas démarrer l'appareil de chauffage après que l'excès de carburant s'est accumulé dans la chambre du dôme avant. Lui laisser le temps de sécher.
9. Ne pas faire fonctionner l'appareil de chauffage sans surveillance.
10. Garder l'appareil de chauffage à une distance minimale de 2 mètres à l'avant et de 90 cm de chaque côté de matériaux inflammables et combustibles.

MISE EN GARDE: Chaud pendant le fonctionnement. Ne pas toucher. Tenir les enfants, les vêtements et les combustibles à l'écart.

SUNFIRE 

LISTED FUEL TYPES: DIESEL/#2 FUEL OIL/KEROSENE
FUEL TANK CAPACITY: 6 GALLONS

GPH RATING: .58 (DIESEL/#2 FUEL OIL) .56 (KEROSENE)
MAX OUTLET TEMP: 1,600°F

ELECTRICAL RATING: 120V, 0.5A, 60HZ (MAX 15A CIRCUIT BREAKER)

WARNING: THIS APPLIANCE IS EQUIPPED WITH A THREE-PRONG (GROUNDING) PLUG FOR YOUR PROTECTION AGAINST ELECTRICAL SHOCK HAZARD AND SHOULD BE PLUGGED DIRECTLY INTO A GROUNDED THREE-PRONG OUTLET.

MINIMUM REQUIRED CLEARANCES FROM COMBUSTIBLE PRODUCTS:
FRONT: 84" SIDES: 36" BACK: N/A
NON-COMBUSTIBLE FLOORING ONLY

MANUFACTURED BY ROCK ENERGY SYSTEMS, LLC
JANESVILLE, WI
GOT QUESTIONS? 1-855-251-1649
SUNFIREHEATERS.COM

MADE IN USA



MP5162
OIL-BURNING
AIR HEATER

Table of Contents

Safety Information:	1
Safety, Codes, and Regulations:	1
Conventions Used in this Manual:	1
Safety Labels:	4
Key Features:	7
Specifications:	8
Getting Started:	9
Identifying Terms:	9
Package Contents:	10
Normal Operation:	12
Controls:	12
Operation Procedure:	12
Operation in Sub-Freezing Temperatures:	13
Optional Accessories:	13
Fuel-Filter Heating Band:	13
Maintenance & Service:	14
Filter & Fuel Tank:	14
Burner Service:	15
General Maintenance:	17
Flame Adjustment:	18
Wiring Diagram (High Voltage):	20
Wiring Diagram (Low Voltage):	21
Troubleshooting:	23
Warranty & Legal Information:	24
WARRANTY INFORMATION	24
PRODUCT REGISTRATION	24
TRADEMARKS	24
COPYRIGHT	24

THIS PAGE INTENTIONALLY LEFT BLANK

SUNFIRE®

CR80

RADIANT HEATER



SunFire: The most advanced, most durable portable multifuel radiant heaters made in the USA

Key Features:

LOW NOISE

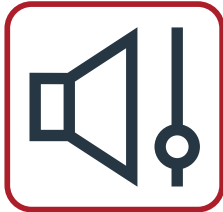

Turn up the heat without turning up the volume

ODORLESS



Say goodbye to the smell and the headache

CLEAN COMBUSTION



Advanced technology for a pure, smokeless flame

ZERO BREEZE/DUST

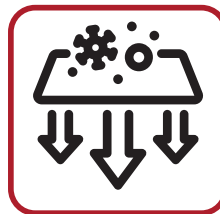

Radiant heat warms without kicking up a storm

SunFire Radiant Heaters are easy to setup and maintain...

...so you can sit back and soak up the glow... season after season.



Specifications:

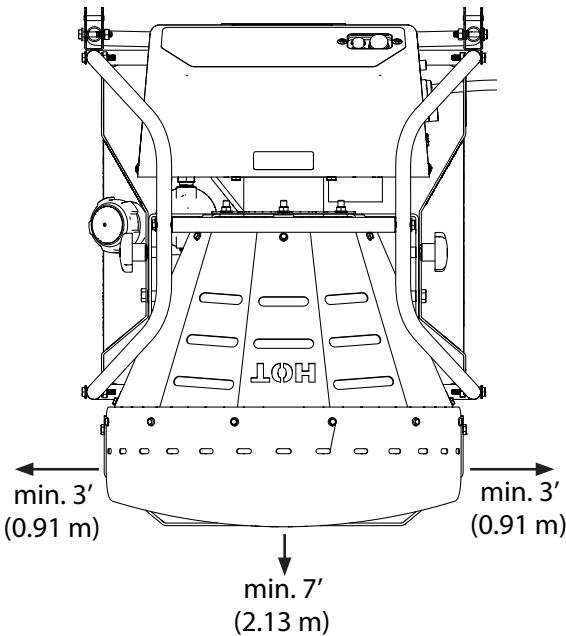
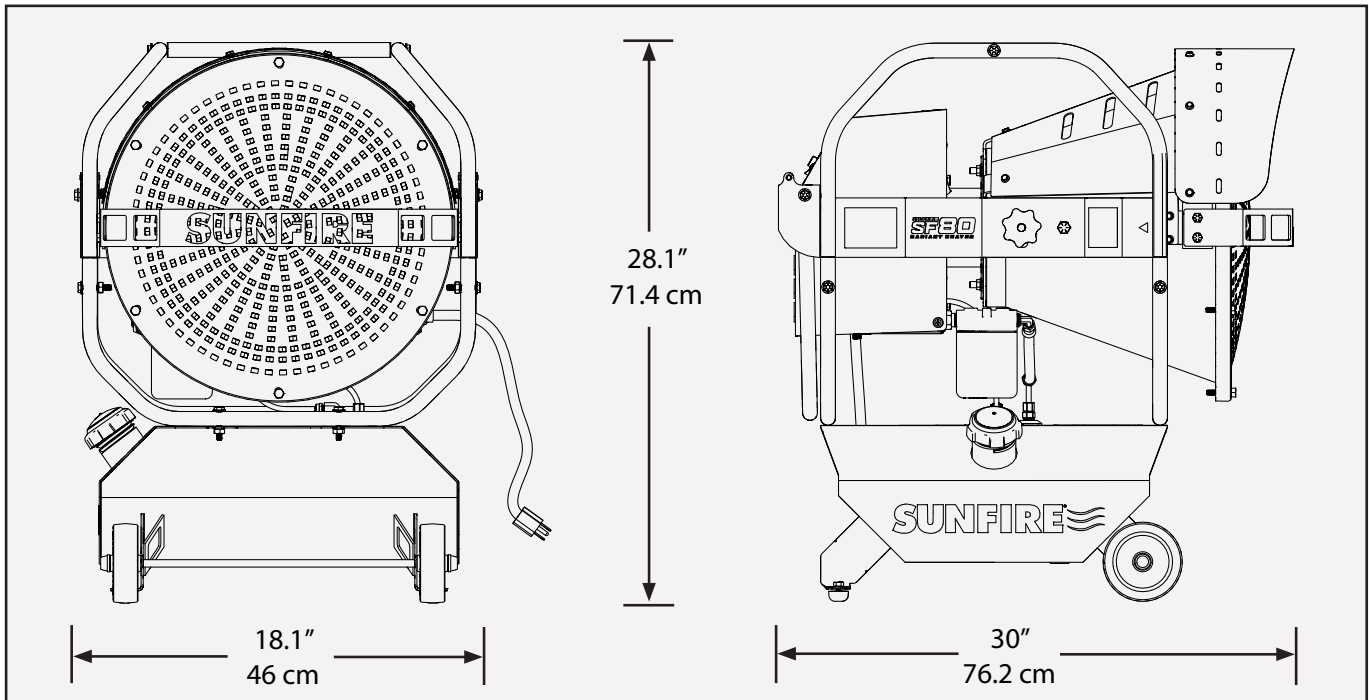

WEIGHT:

Tank empty: 85 lbs (38.6 kg); Tank full: 127 lbs (57.6 kg)

DIMENSIONS:

L: 30" (76.2cm) W: 18.1" (46cm) H: 28.1" (71.4cm)

MINIMUM CLEARANCE TO COMBUSTIBLE MATERIAL:

Front: 84" (213 cm) Left/Right Side: 36" (91 cm)

Back: N/A Below: For use on non-combustible flooring or with heat-rejecting mat

FUEL REQUIREMENT:

Diesel, No. 2 Heating Oil, Kerosene

FUEL INPUT:

0.58 gal/h Diesel; 0.56 gal/h Kerosene

FUEL TANK CAPACITY:

6 U.S. gallons (22.7 L)

ELECTRICAL REQUIREMENT:

0.5A, 120V / 60Hz 1-Phase

OPERATING TEMPERATURE RANGE*:

-20°F (-28.9°C) to 80°F (26.7°C)

*Fuel-temperature considerations are necessary when operating in sub-freezing temperatures. See product manual sections **NORMAL OPERATION** and **OPTIONAL ACCESSORIES** for more information.

Getting Started:

IDENTIFYING TERMS:

Please familiarize yourself with the parts of the heater as they will be referred to throughout this manual:

- | | | |
|--------------------------|--|------------------------|
| 1. Power Cord | 9. Burner Cover | 16. Handle Locking Pin |
| 2. Fuel Tank | 10. PRIME Switch | 17. Heat Shield |
| 3. Fill Cap & Fuel Gauge | 11. Controls (See Normal
Operation section) | 18. Dome Visor |
| 4. Fuel Pickup Hose | 12. Support Frame | 19. Dome Guard |
| 5. Fuel Return Hose | 13. Wheel x2 | 20. Dome Face |
| 6. Fuel Filter Element | 14. Foot x2 | |
| 7. Fuel Filter Head | 15. Adjustable Handle | |
| 8. Burner | | |

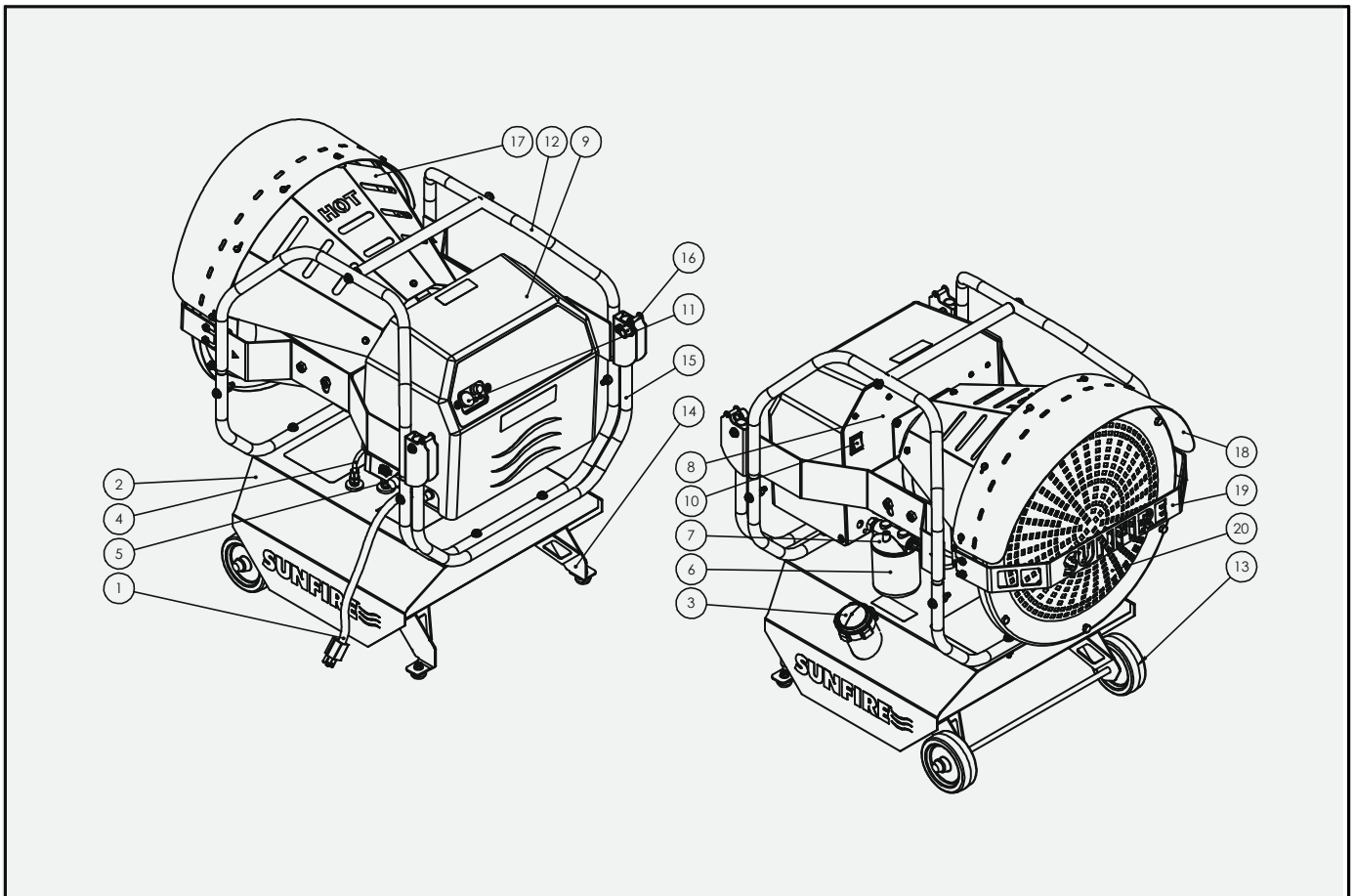

Getting Started:

PACKAGE CONTENTS:

The SunFire CR-80 is shipped preassembled and ready for NORMAL OPERATION. No assembly is required, though adjustment of the levelling feet may be needed. To adjust the foot, loosen the locking nut on the threaded foot post and rotate the foot to adjust the height. Tighten the locking nut when finished.

Normal Operation:

This section will cover normal orientation and operation of the SunFire CR-80.

TO OPERATE THE HANDLE:

The unit will ship with the handle secured in place by a hook and loop retaining strap (not shown). This should be left on the frame and reused when transporting the heater in the future. To raise the handle position, undo the retaining strap. Then, lift the handle.

Reuse the retaining strap to secure the handle in the lowered position when transporting the heater.

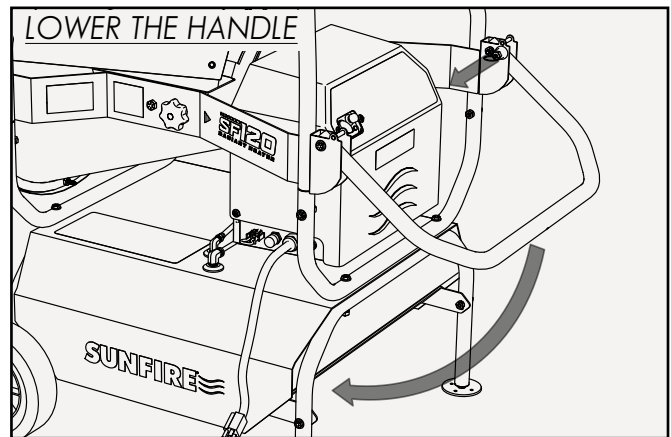
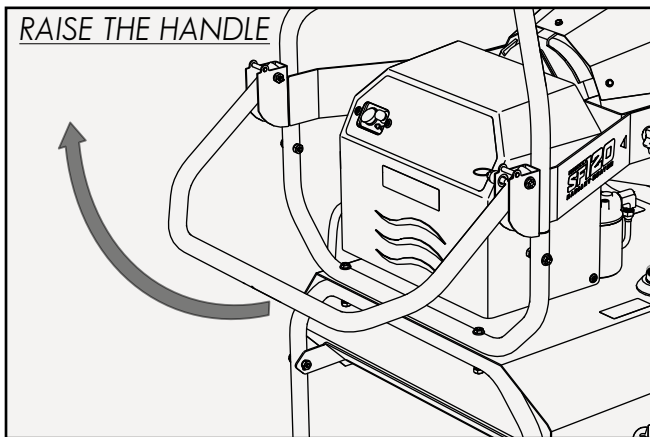

⚠ DANGER

When the heater is in use and connected to the power supply, it should never be moved, handled, or refilled and no maintenance should be performed on it. Allow the unit to cool completely before moving.

THIS PAGE INTENTIONALLY LEFT BLANK

Normal Operation:

CONTROLS:

The unit's controls are labeled and located on the burner cover.

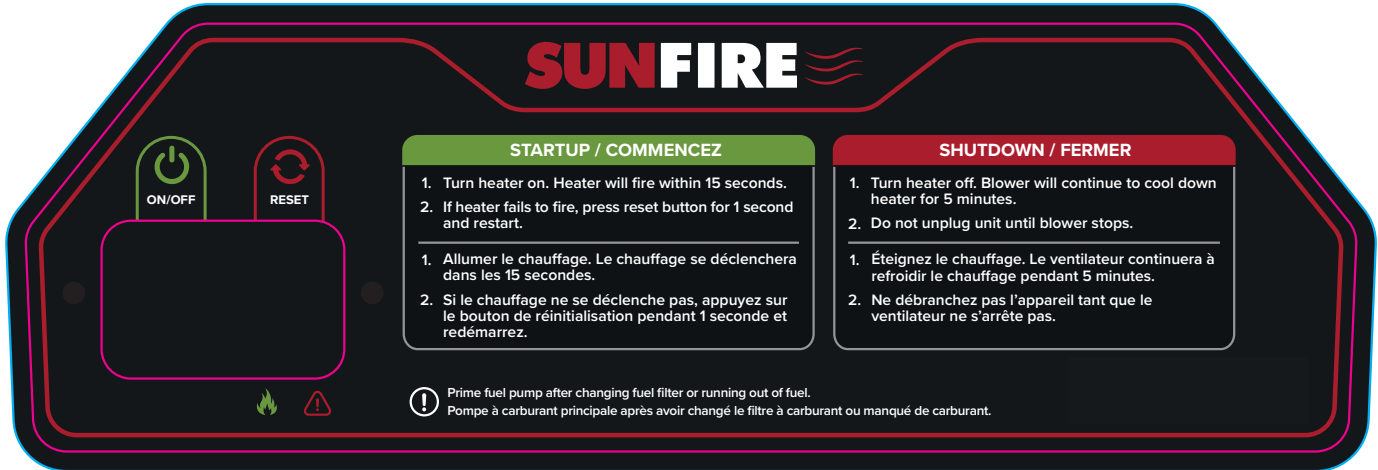

OPERATION PROCEDURE:

Keep the unit on a level, non-combustible surface at all times. If the unit is resting at a 25° angle or more, the tip switch will turn the heater off and/or prevent the heater from starting.

1. Add Diesel, No.2 heating oil, or kerosene to the fuel tank, if a need is indicated by the fuel gauge. Approved fuels can be mixed at any ratio.
2. Plug the unit's power cord into a grounded extension cord capable of supplying proper amperage and position the heater in a well ventilated area that provides safe clearances.
3. Press and hold the PRIME switch (located on the back side of the burner) until the fuel system is filled with fuel and purged of air (pump becomes quieter, fuel begins to flow through the return line). NOTE: For a new unit, or if the heater stopped because of low fuel, additional priming cycles may be necessary.
4. Toggle the control switch to the ON position.
5. The blower will begin to operate and run for 15 seconds prior to ignition (pre-purge).
6. After the burner ignites, the GREEN LIGHT on the control panel will illuminate, indicating that the burner is on and the flame sensor can see the flame.
7. If the heater shuts off unexpectedly and the RED LIGHT on the control panel is illuminated, the unit must be reset (by pressing the RESET button) before resuming operation. Do not reset the unit more than two (2) times without troubleshooting the root cause of the issue. (see Troubleshooting section)
8. When shutting down the heater, turn power switch to the OFF position but **DO NOT UNPLUG THE HEATER**. Allow the burner to complete the post-purge cycle (5 minutes) before disconnecting power.

For a new unit, the first hour of operation may produce light smoke and odor as dust and manufacturing lubricants are cleared from the system. This should dissipate with continued use.

⚠ DANGER

Do not attempt to RESET the primary control of the heater more than twice. Stop and troubleshoot the cause of the issue. Repeated attempts to reset the unit can cause a risk of fire.

⚠ WARNING

Allow the heater to complete its post-purge of heat and fuel vapors to reduce the risk of a fire hazard or damage to the unit.

OPERATION IN SUB-FREEZING TEMPERATURES:

Diesel and No.2 heating oil can begin to solidify at temperatures below 32°F (0°C). Kerosene can be mixed with Diesel fuel / No.2 heating oil in the tank to lower the freezing point of the fuel. If the heater will regularly be used in an environment where the unit has been allowed to cool to below 0°F (-18°C), a fuel-filter heating band will be necessary. On an initial cold start, with the unit plugged in and the heating band allowed to warm for ~30 minutes, use the prime switch to circulate warm oil through the system for a couple of minutes prior to starting. Use of 100% kerosene may also be necessary in this scenario.

Optional Accessories:

FUEL-FILTER HEATING BAND:

SunFire heaters can be fitted with a fuel-filter heating band to assist fuel flow in cold conditions.

HEATING BAND PLACEMENT:

Slip the heating band securely around the filter element. Remove the heating band before servicing or replacing the filter element.

HEATING BAND CONNECTION:

To connect the heating band, first **unplug the heater from its power source** and remove the cover from the burner housing (see Burner Service section). Feed the wire leads of the heating band through the grommeted opening in the underside of burner housing and refer to the wiring diagram in this manual to connect them to the terminal block. Replace the housing cover when finished.

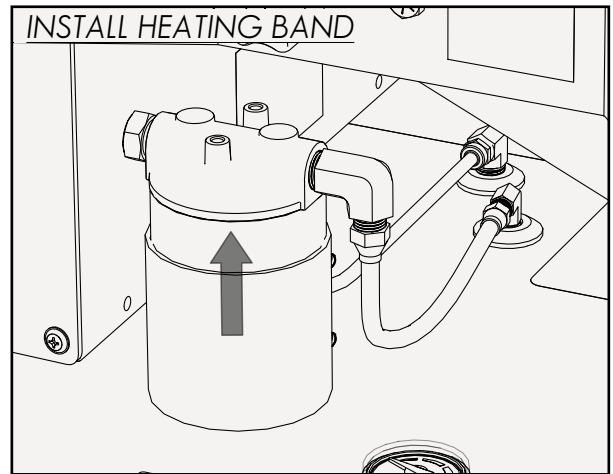

CAUTION

Do not use the fuel-filter heating band in temperatures above 40°F (4.4°C), as volatile vapors may form in the fuel system, resulting in a hazard and/or damage to the product.

Maintenance & Service:

Maintaining your heater is important for prolonging the life of the product and keeping it operating in peak condition. Inspect the heater before each use and return the unit to optimal condition before resuming normal operation. Perform regular maintenance on the heater at the beginning and end of each heating season.

⚠️WARNING

Any time a component or any part of the burner is disassembled or replaced for service or maintenance, perform a complete operational test after reassembly to verify that the heater operates correctly. Failure to verify proper operation could result in severe personal injury, death, or substantial property damage.

FILTER & FUEL TANK:

The fuel filter and tank should be serviced annually, at a minimum, or whenever a clog or poor fuel quality is suspected. Over time, water and silt can collect in the fuel tank and should be removed by draining the tank.

REPLACING THE FUEL FILTER:

The heater's fuel filter should be replaced before each heating season, after seasonal or long-term storage of the unit, or whenever a clog or poor fuel quality is suspected. Being careful to catch and contain any fuel that may spill, rotate the filter element to separate it from the filter head. Replace the filter with a genuine SunFire filter element. Apply a small amount of clean oil to the rubber o-ring. Tighten the filter snugly after the o-ring contacts the filter head. Do not over tighten.

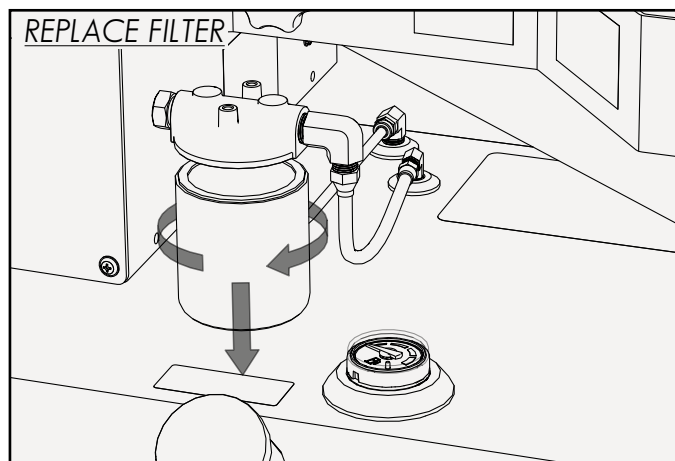

DRAINING THE FUEL TANK:

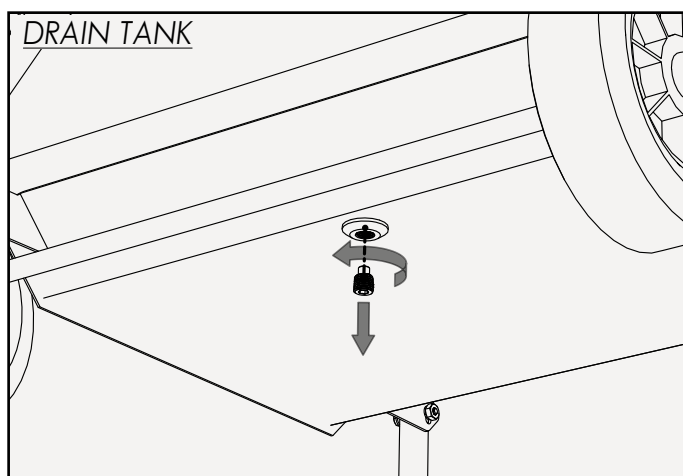

The heater's fuel tank should be drained after each heating season, before long-term storage or transport, or whenever poor fuel quality is suspected. Being careful and prepared to catch and contain the entire contents of the tank, use a 1/4" hex key to remove the drain plug from the tank and allow the contents of the tank to drain completely. Apply fresh thread sealant, replace the drain plug, and confirm that it has sealed properly upon refueling.

The heater's fuel system will need to be primed after the unit's fuel filter or tank is serviced, or when the heater has been run out of fuel. Use the PRIME switch on the back of the burner housing to prepare the heater for normal operation.

BURNER SERVICE:

The burner assembly should be serviced seasonally, at a minimum, or whenever excess smoke is present or a clog or poor fuel quality is suspected. For inspection or service, the nozzle subassembly will need to be removed from the heater and the flame sensor, igniter electrode, and combustion chamber should be inspected.

⚠ WARNING

Do not attempt to handle burner components unless the unit has been unplugged and cooled completely. Components can be hot and could cause severe personal injury.

TO SERVICE THE BURNER ASSEMBLY:

1. Use a Phillips-head screwdriver to remove the four (4) screws securing the burner cover to the unit. Then, remove the burner cover.

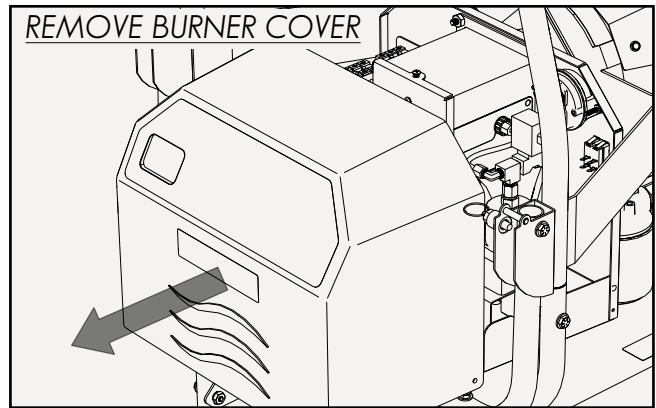
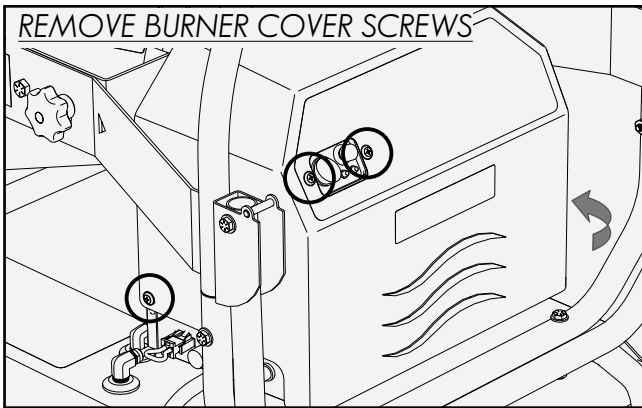

2. Use a Phillips-head screwdriver to remove the screw securing the square access door closed. Then, swing the door down.

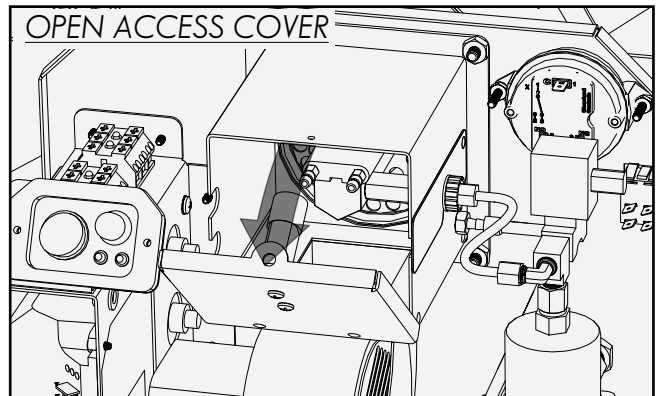
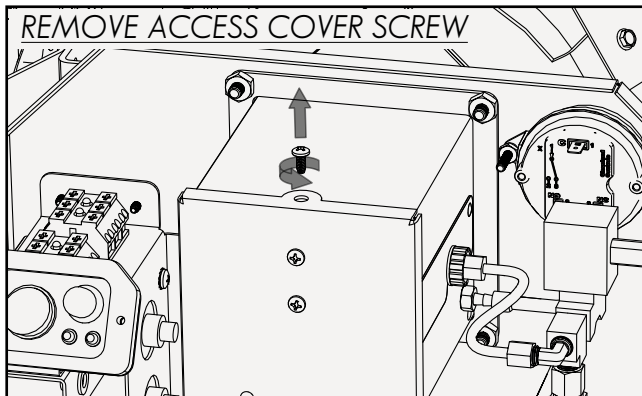

3. Grab and pull the end of the ignition wires (not shown) to disconnect them from the electrode terminals. Then, slide the rubber wire grommets from the housing and move the wires aside.

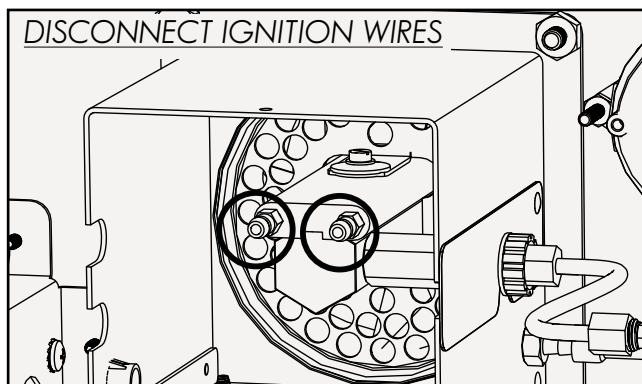

CR-80 internal components and locations may differ slightly.

For the CR-80, disconnect the flame-sensor wires from the F1 & F2 terminals of the primary control (in addition to the ignition wires) to allow for removal of the nozzle-line assembly.

Maintenance & Service:

TO SERVICE THE BURNER ASSEMBLY (CONT.):

- Use a 9/16" wrench to avoid rotation of the bulkhead fitting of the nozzle subassembly inside the burner box (circled area) and use a 7/16" wrench to remove the fuel line (outside the box). Then, loosen the knurled nut securing the nozzle subassembly to the burner housing.

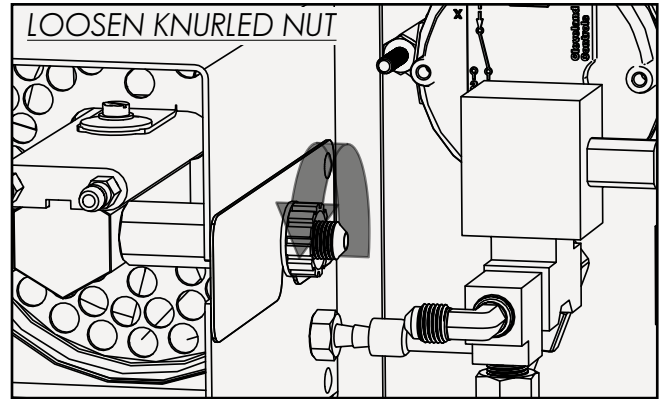
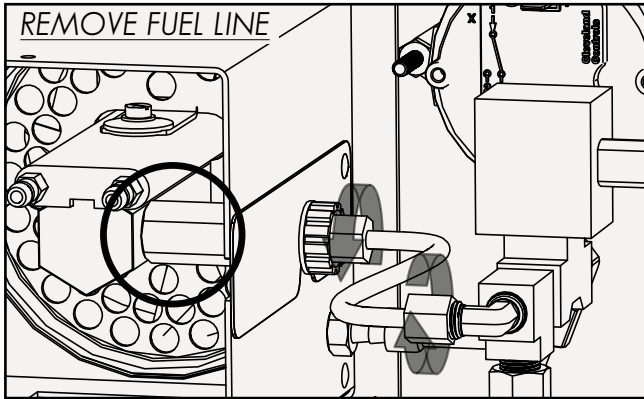

- Lift the side-retaining plate to rotate it on its hinge. Then, lift the rear of the nozzle subassembly and pull to remove the nozzle subassembly from the burner assembly. With the nozzle subassembly removed, use an inspection mirror to visually inspect the interior of the combustion chamber for signs of fuel buildup or missing portions of the insulation lining.

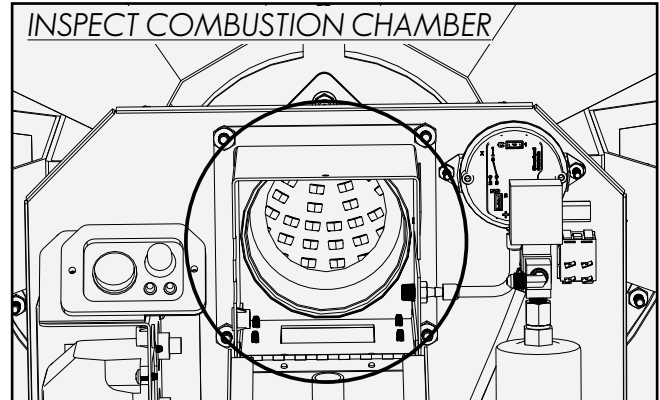
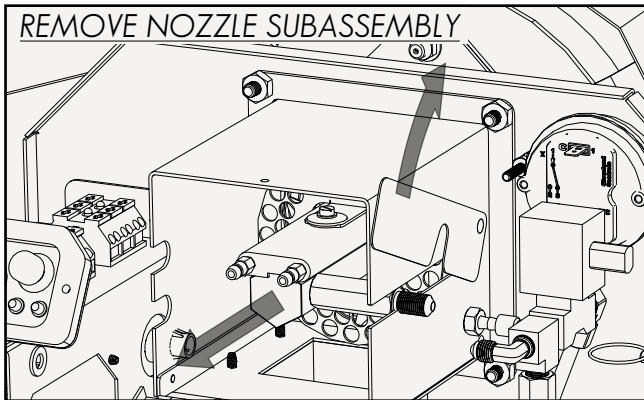

Some visible cracks in the insulation material are normal. If portions of the insulation are broken or missing, replace the insulation before resuming operation of the unit. Contact SunFire technical service for assistance.

- Inspect the flame sensor for dirt or damage. Use a soft, damp rag or cotton swab to clean the sensor. For the CR-80, remove the screw and flame-sensor bracket to clean the sensor eye. Disconnect the wires (not shown) from the F1 & F2 terminals of the primary control in order to replace the flame sensor.

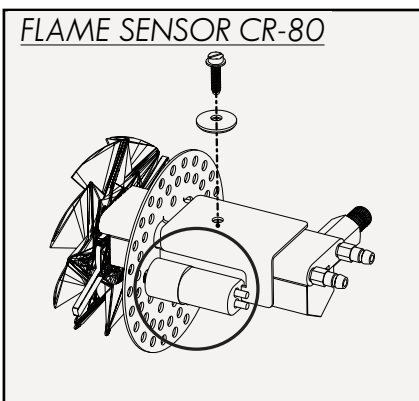

⚠ CAUTION

If the flame sensor shows signs of damage, troubleshoot the unit to determine and correct the cause and replace the flame sensor before resuming operation of the unit.

Contact SunFire technical service for assistance.

BURNER SERVICE (CONT.):

TO SERVICE THE BURNER ASSEMBLY (CONT.):

- Using a 5/8" wrench, remove the nozzle, replace it with a new SunFire-OEM nozzle, and tighten the nozzle to 20 ft lb of torque to ensure a tight seal but avoid damage due to overtightening. Also, take care not to damage or disturb the igniter electrodes or metal spinner fins during this process. With the new nozzle in place, ensure that the electrode tips are aligned with the face of the nozzle. Use a slotted screwdriver or 1/4" driver to adjust the screw on the top of the electrode assembly to reposition the electrode, if necessary. Use a soft, damp rag to wipe any carbon buildup from the spinner and electrode.

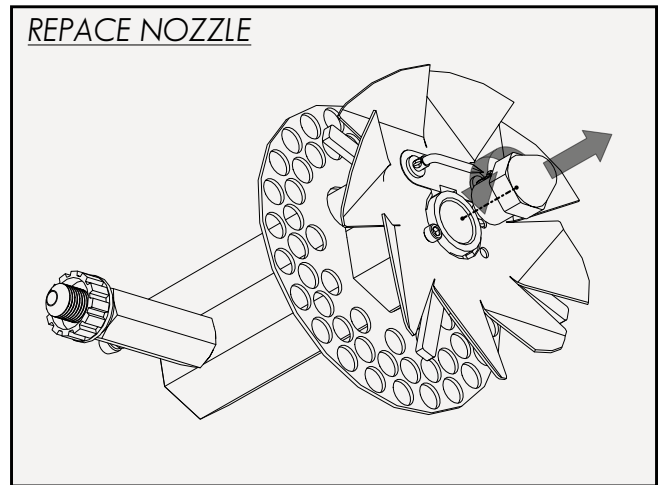

If the electrode shows signs of damage or wear, replace the electrode assembly before resuming operation of the unit.

⚠ WARNING

Only use authentic SunFire parts. Inspect the nozzle adapter before replacing the nozzle. If the threads have been damaged or show score marks, replace the entire nozzle-line assembly. Contact your local SunFire dealer or SunFire technical service for assistance.

Confirm that the electrode tines are positioned properly before returning the nozzle subassembly to the burner.

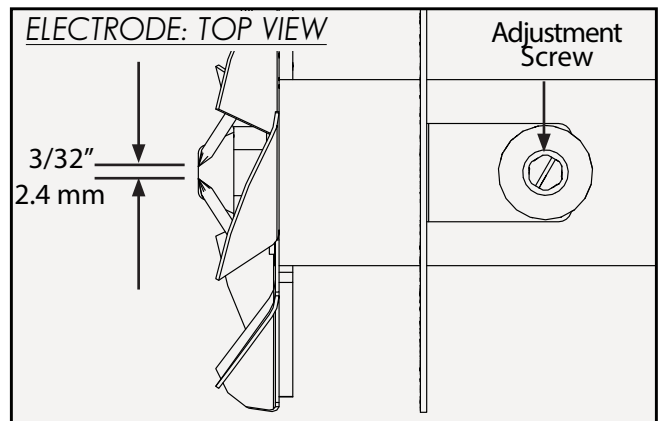
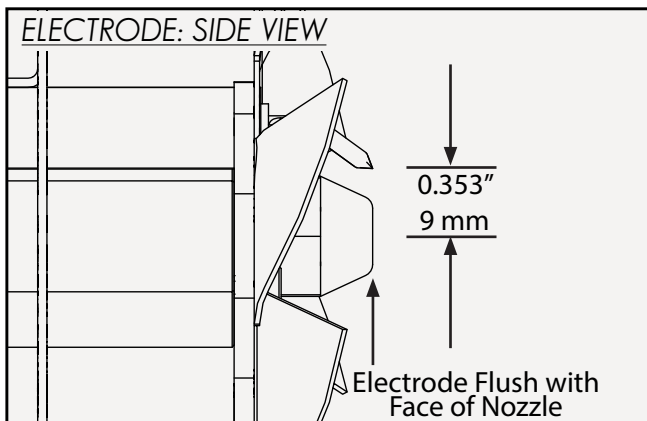

When inspection and service of the burner components has been completed, reverse the disassembly process and return all assemblies to their factory position before resuming normal operation.

NOTICE

Use care when tightening the oil line fitting to oil tube extension. Tighten securely, but do not crossthread or overtighten.

GENERAL MAINTENANCE:

Inspect the heater for damage and wear before each use. **Do not attempt to operate a damaged heater.** To make inspection easier, regularly use a soft, damp rag to clean the heater.

Seasonally, or after heavy use or transit, inspect the fasteners and connections, especially around the dome face and fuel hoses, and tighten any fasteners, hoses, or wires that may have loosened.

Maintenance & Service:

FLAME ADJUSTMENT:

Due to variations in nozzle tolerances, fuel quality, and geographical location, adjustments may be required periodically to maintain optimal operation.

⚠ DANGER

During this procedure, dangerous electrical voltage will be present at the wiring connections. Only qualified technicians should perform this procedure. Use proper safety equipment and practices. Only interact with the components described in the instructions during this procedure. Securely reattach the burner cover before resuming normal operation.

TO ADJUST THE FLAME:

1. With the heater off, remove the burner cover and locate the fan-voltage regulator and white adjustment screw on the top of the burner-blower housing. If adjustment of the blower-fan voltage is needed, gently turn the screw with a small screwdriver to modulate the voltage. Use a voltage meter at the VDC terminals of the voltage regulator to measure the voltage supplied to the blower fan. **Do not exceed 13 VDC.**
2. Start the unit and watch it as it starts up. A small amount of white smoke at ignition is normal, but should not last more than a few seconds and should not be black. If the unit will not establish a flame, or the flame is very poor, set the voltage regulator to the minimum setting (~10 VDC) and reattempt to start the unit. If the unit still will not establish a flame, it may require service. (Refer to the Troubleshooting section)
3. When the heater has established a flame, slowly increase the voltage to increase the air supply, if needed, until no flame or smoke is emitted from the dome face. Allow the unit to run for 5 minutes, to warm up.
4. If the voltage is set to minimum (~10 VDC), or approaches 13VDC, but will not bring the flame into adjustment (especially after changing the nozzle), the fuel pump may need to be adjusted. Return the voltage regulator to the minimum setting. Then, use a screwdriver (hex key on some models) to slowly adjust the pump-flow-rate screw (near the pump intake). Counter-clockwise adjustment reduces fuel flow. Clockwise adjustment increases fuel flow. Only minor adjustments of ~1/4-turn or less should be required.
5. When the heater is warm, the dome face should have an orange glow with no smoke or flame emitted. If the dome face does not glow after the heater has warmed up, the flame is weak and needs less air or more fuel. If the flame is smoky, it needs more air or less fuel. Use the voltage regulator and pump adjustment to bring the warmed heater's flame into adjustment.
6. When the flame is well adjusted, turn the heater off and let it complete its cooldown cycle. Then, restart the heater and confirm the flame adjustment on startup. Repeat the process if necessary. Replace the burner cover before resuming normal operation.
7. Inspect the flame regularly, when the heater is completely warm or is starting from completely cool, to ensure that it is well adjusted.

Whenever operating conditions change substantially (i.e.: temperature, altitude, fuel mixture), check the flame and adjust it if needed.

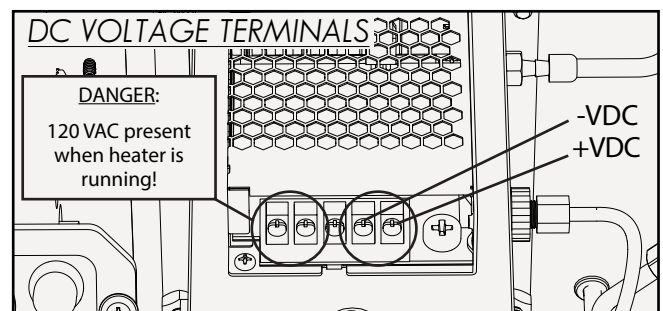
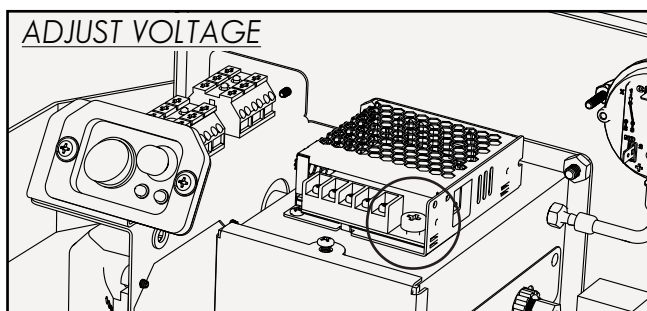

THIS PAGE INTENTIONALLY LEFT BLANK

WIRING DIAGRAM (HIGH VOLTAGE):

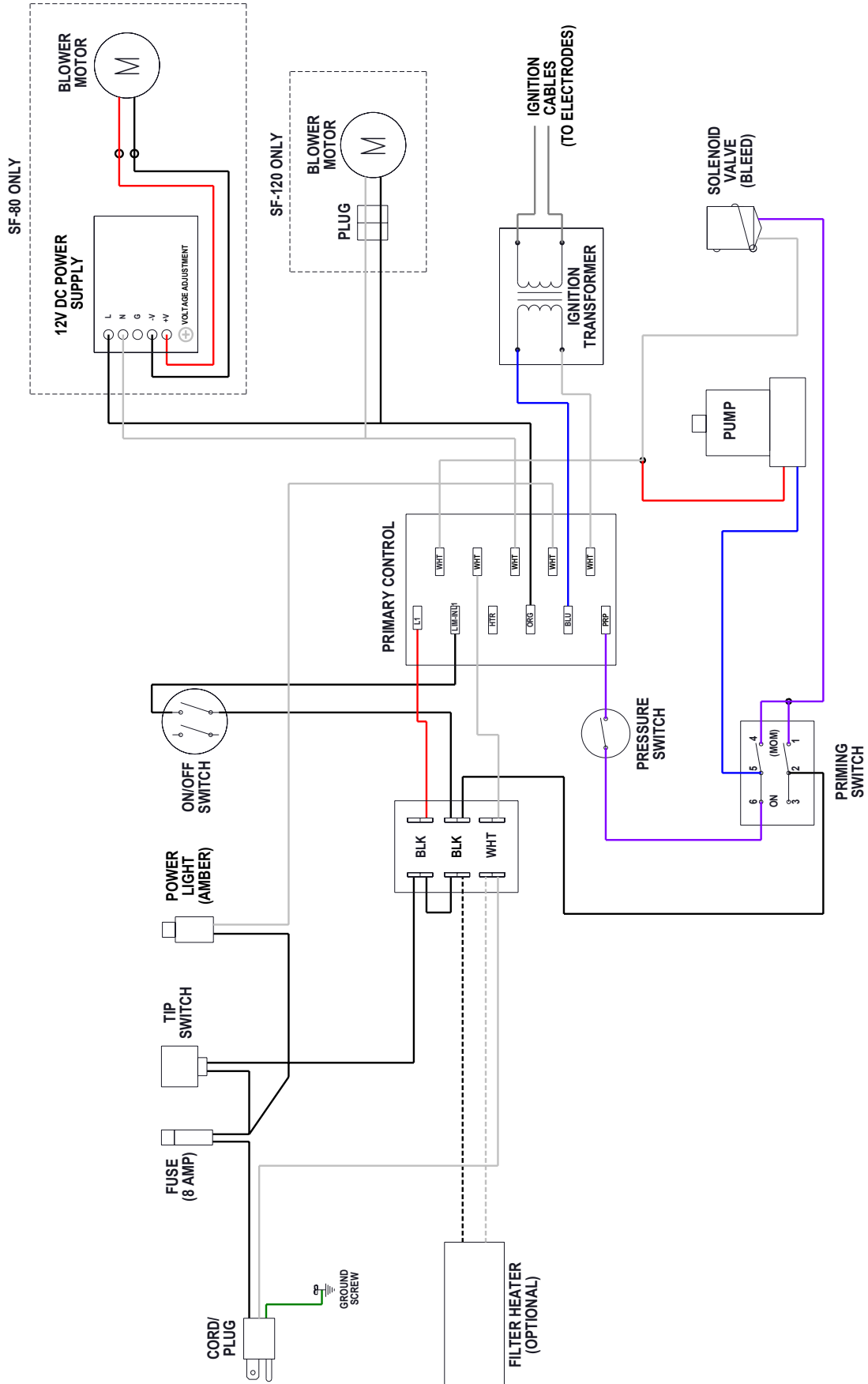

WIRING DIAGRAM (LOW VOLTAGE):

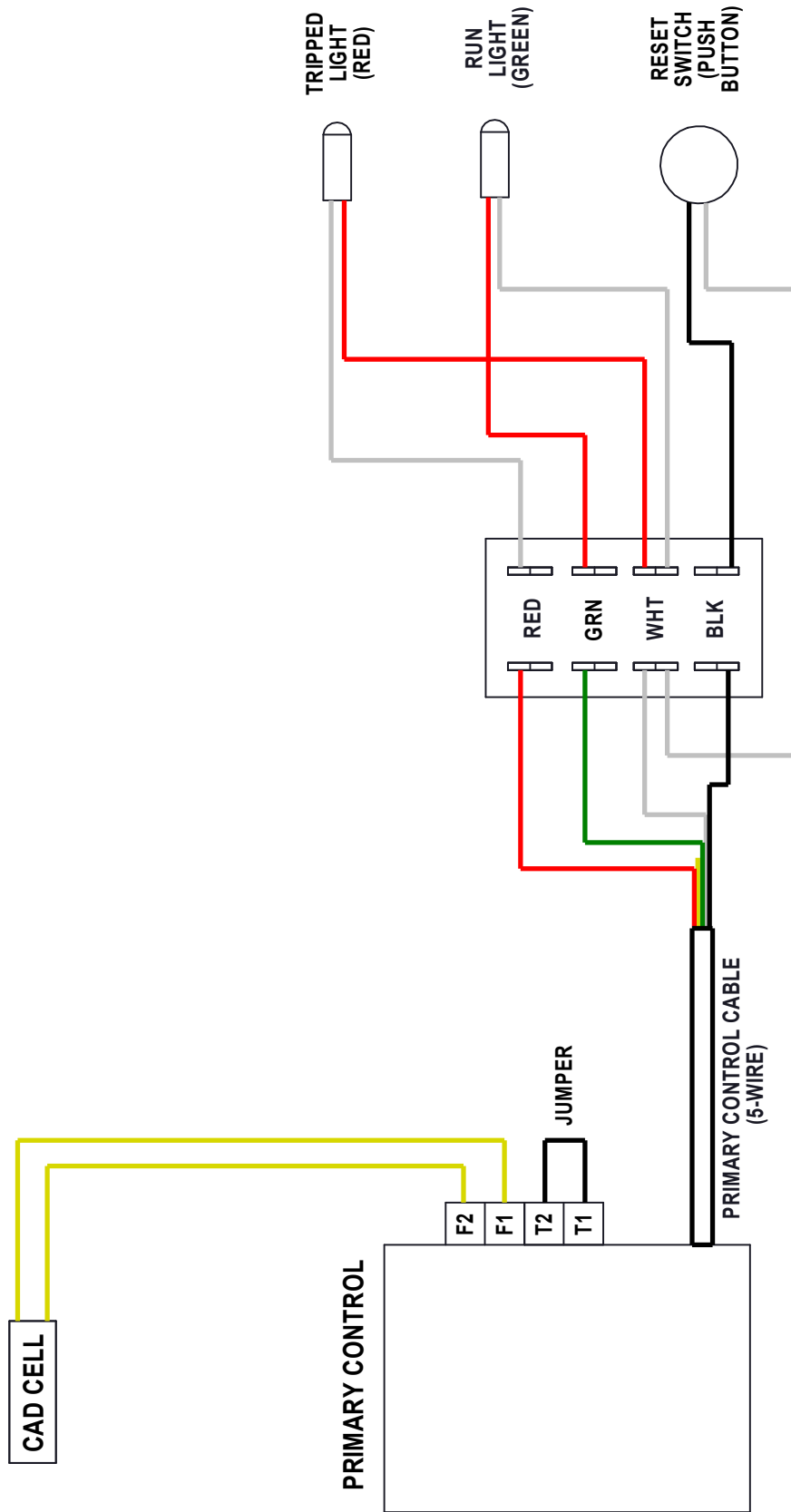

THIS PAGE INTENTIONALLY LEFT BLANK

Troubleshooting:

SYMPTOM	POSSIBLE CAUSE	CORRECTIVE ACTION
1. Will not start.	Main electrical power circuit breaker tripped or blown fuse (AMBER light off)	Reset breaker or replace fuse. If power is present but AMBER light is off, replace bulb.
	Primary control safety tripped (RED light illuminated)/primary control defective	Reset/test components, replace if needed. Contact SunFire or your local dealer.
	Flame sensor is sensing light (GREEN light on) / defective	Point the dome face away from any bright light sources. If problem persists, contact SunFire or your local dealer.
	Tip switch contacts are open	If plugged in and AMBER light is on. Make sure SunFire unit is level. If level, tip switch may be defective.
2. Attempts to fire but does not establish a flame	Unit is not primed	Use the PRIME switch to fill the fuel system.
	Clogged nozzle	Replace the nozzle.
	Dirty fuel filter	Change the fuel filter.
	Air bubble in fuel line	Use the PRIME switch to clear the fuel system of air.
	Suction Leak	Tighten all fuel-pickup pipe fittings and make sure the fuel filter is tightened snugly to the filter head.
	Ignition system defective	Replace defective component.
3. Fires and then persistently fails within 30 seconds	Flame sensor is misaligned / dirty / defective	Clean flame sensor with a soft, damp cloth and confirm that it is oriented toward the combustion chamber when in operational position. Replace if defective.
4. Fires and then fails after 30 seconds / Heater experiences intermittent shutdown NOTE: If the pump sounds loud at times during normal operation (like during initial priming), this typically indicates either a suction leak or air bubble in the fuel line.	Air bubble in fuel line	Use the PRIME switch to clear the fuel system of air. If the problem persists, remove the fuel filter and fill it with fuel. Then, reinstall the filter and reattempt priming.
	Suction Leak	Tighten all fuel-pickup pipe fittings and make sure the fuel filter is tightened snugly to the filter head. Do not over tighten.
	Dirty fuel filter	Change the fuel filter.
	Clogged nozzle	Replace the nozzle.
	Contaminated fuel supply	Drain tank from plug, clean and fill with clean fuel.
	Improper power supply	Check power supply. If using a generator, run generator for 20 minutes and retry. If using an inverter, try a clean power supply. Try different power supply.
5. Black smoke or whisking flames protrude through holes in dome face (Light flame whisking may occur at cold start but should dissipate quickly)	Nozzle is dirty or clogged	Replace the nozzle.
	Flame needs adjustment	See Flame Adjustment section.
6. Small flame/low heat output	Flame needs adjustment	See Flame Adjustment section.
	Dirty fuel filter	Change the fuel filter.
	Clogged nozzle	Replace the nozzle.
	Fuel pump defective	Contact SunFire or your local dealer.

If your issue was not described here, or for further assistance, please contact your local AUTHORIZED SUNFIRE DEALER, find more information at sunfireheater.com/support, or call the manufacturer directly at (855) 251-1649.

Warranty & Legal Information:

WARRANTY INFORMATION

Rock Energy Systems, LLC (SUNFIRE) warrants that its Heaters and component parts will be free from defects in material and workmanship for a period of two (2) years from the date of purchase when properly assembled, operated, and maintained in accordance with the assembly and maintenance instructions, safety guides and labels contained with each unit. If any component proves defective in either material or workmanship during the limited warranty period, SUNFIRE at its option, may repair the defective part or equipment or replace the equipment or relevant parts. Proof of purchase and warranty qualification must be established at time of all claims.

BILL OF SALE: A copy of the bill of sale must be provided at time of return.

CLAIM PROCEDURE: Contact manufacturer at (855) 251-1649 or an AUTHORIZED SUNFIRE DEALER for all technical support and claims. You may also visit sunfireheaters.com/warranty.

This limited warranty does not apply to heater, component or replacement part damage resulting from incorrect assembly, misuse, abuse, accident, act of God, neglect, mishandling, contaminated fuel, modification, incorrect environments, or wear from ordinary use.

The warranty set forth above is the exclusive warranty provided by SUNFIRE and all other warranties, including any implied warranties or merchantability or fitness for a particular purpose, are expressly disclaimed. In the event any implied warranty is not hereby effectively disclaimed due to operation of law, such implied warranty is limited in duration to the duration of the applicable warranty stated above. The remedies set forth above are the sole and exclusive remedies available hereunder. SUNFIRE will not be liable for any incidental or consequential damages directly or indirectly related to the sales, handling or use of the equipment, and in any event SUNFIRE in connection with the equipment, including for claims based on negligence or strict liability, is limited to the purchase price.

PRODUCT REGISTRATION

Help us serve you better by registering your heater.
Receive product updates, future specials, and offers.

RAPID REGISTRATION QR CODE



sunfireheaters.com/register-heater

TRADEMARKS

The SUNFIRE logo is a trademark of Rock Energy Systems, LLC. All other brand or product names mentioned are the registered trademarks or trademarks of their respective owners.

COPYRIGHT

Copyright © 2023 Rock Energy Systems, LLC. All rights reserved. No part of this publication may be reproduced, or distributed without the prior written permission of Rock Energy Systems, LLC. Subject to change without notice.

THIS PAGE INTENTIONALLY LEFT BLANK

SUNFIRE[®]

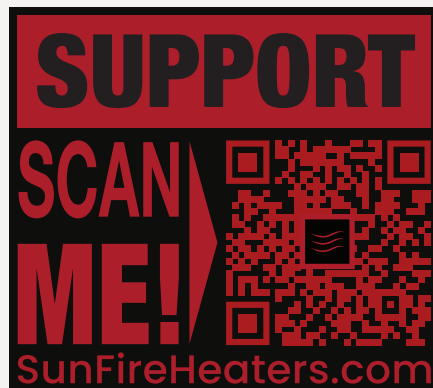

Rock Energy Systems, LLC
4109 Capital Circle, Janesville, WI 53546
SunFireHeaters.com

SUNFIRE is a registered trademark of Rock Energy Systems, LLC

81012255 - Rev A.1 - September 2024